



TOP MOUNT PUMPER
WILLIAMSTON, MI

1.517.543.6400



Chassis

- Spartan Metro Star MFD 10" Raised Roof
- Seating for 6
- Cummins L9 450 hp Engine
- Allison 3000 Series EVS Transmission
- Advanced Protection System
- Extreme Duty Interior
- V-Mux Display
- Advanced Climate Control System
- Front Axle: 20,000; Rear Axle: 27,000
- 24" Front Bumper Extension
- 221" Wheelbase

Pump & Plumbing

- Waterous CX 1500 GPM Pump
- 1000 Gallon Tank
- 2.5" Left Side Discharge
- 2.5" Right Side Discharge
- 2.5" Rear Discharge
- 4.0" LH LDH Discharge
- (2) 1-3/4" Speedlay
- 2.5" Hosebed Preconnect
- 3" TFT Extend-a-Gun
- 5" Rear Intake
- 3" Tank to Pump
- 2" Tank Refill
- FoamPro 2002 w/ 30 Gallons Foam

Body

- High Strength Aluminum Body
- Vibra-Torque Body Mounting System
- Speedliner Compartment Finish
- Driver Side Ladder Storage
- Treadplate Hosebed Cover w/ Integrated Arrowstick
- ROM Roll-up Doors
- LED Compartment Lighting
- 13.5" Rear Tailboard
- Storage for 8 SCBA bottles
- Split Depth Storage Compartments
- Duo Safety Ladder Package: 24 ft 2 Section, 14 ft Roof, and 10 ft Attic
- Pike Pole Storage
- Whelen LED Lighting Package

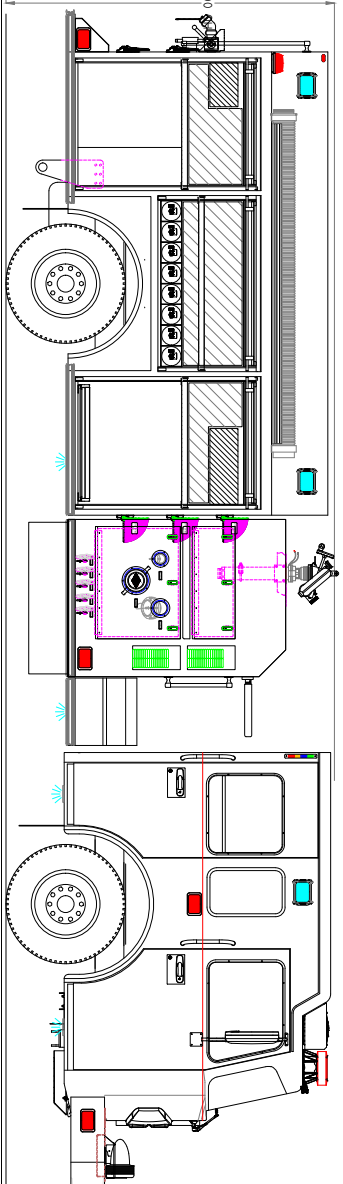
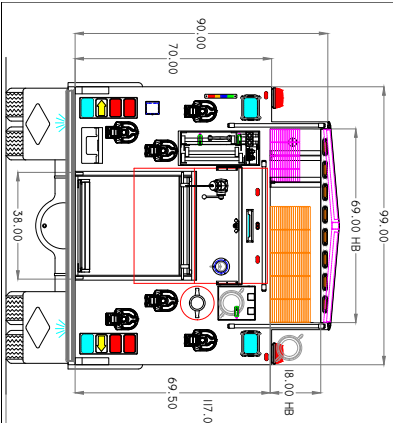
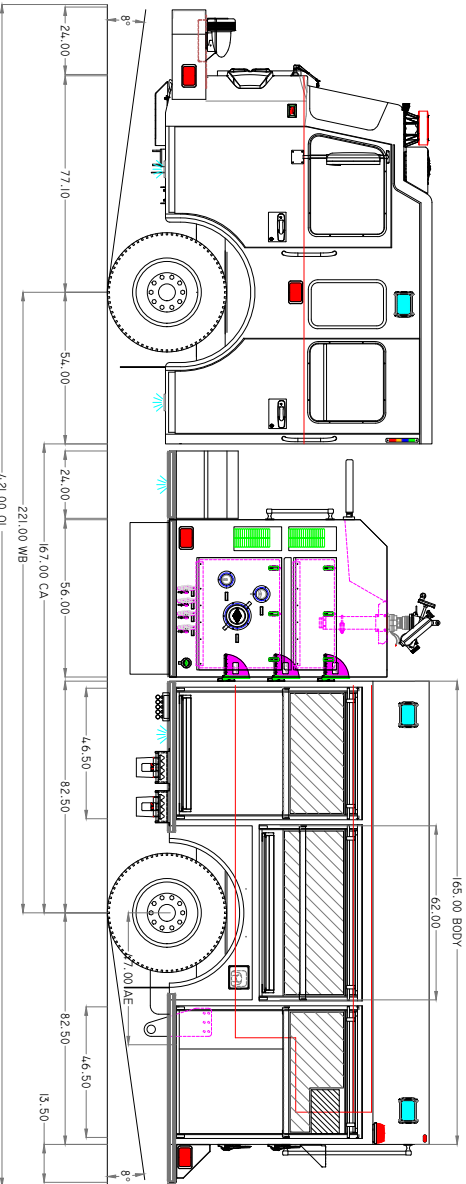
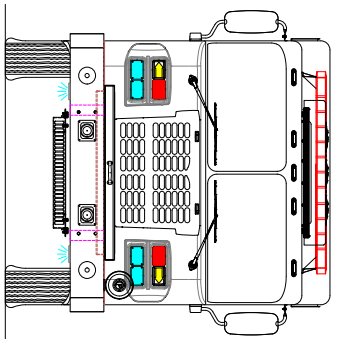
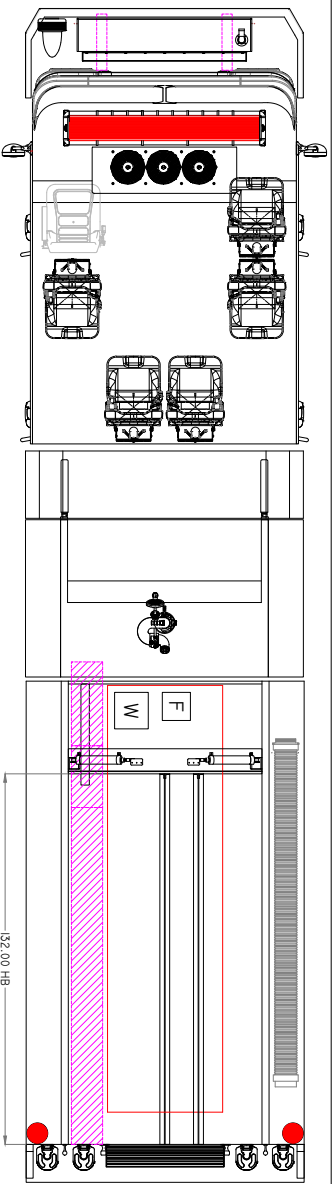

CHASSIS: SPARTAN METRO STAR MFD ORR
 ENGINE: CUMMINS L9 450HP
 TRANSMISSION: ALLISON 3000 EVS
 AXLES: 20,000# FRONT / 27,000# REAR
 MODEL: STAR PUMPER
 WATER/FOAM: 1000 / 30 GALLONS
 PUMP: WATEROUS CXS 1500GPM
 FOAM SYSTEM: FOAMPRO 2002
 GENERATOR:

DOOR FRAMED OPENINGS	
COMPARTMENT	DOOR FRAMED OPENING
L1	46.5-W X 69.0-H
L2	46.5-W X 69.0-H
L3	46.5-W X 69.0-H
R1	46.5-W X 65.0-H
R2	62.0-W X 55.5-H
R3	46.5-W X 65.0-H
B1	38.0-W X 41.0-H

CUSTOMER
 THIS DRAWING IS A CLOSE APPROXIMATION OF YOUR FIRE APPARATUS. IN ALL CASES WHERE THE DRAWING AND THE WRITTEN SPECIFICATION DIFFER, THE SPECIFICATION SHALL PREVAIL. THE WRITTEN SPECIFICATION REPRESENTS WHAT YOU WANT IN YOUR FINISHED PRODUCT. SPARTAN EMERGENCY RESPONSE BUILDS TO THE WRITTEN SPECIFICATION AND THE DRAWING SHALL BE CONSIDERED SECONDARY.

PROPRIETARY AND CONFIDENTIAL
 THE INFORMATION CONTAINED HEREIN IS THE SOLE PROPERTY OF SPARTAN EMERGENCY RESPONSE. ANY REPRODUCTION IN PART OR AS A WHOLE WITHOUT THE WRITTEN SPECIFICATION REPRESENTS WHAT YOU WANT IN YOUR FINISHED PRODUCT. SPARTAN EMERGENCY RESPONSE BUILDS TO THE WRITTEN SPECIFICATION AND THE DRAWING SHALL BE CONSIDERED SECONDARY.

REV	DATE	DESCRIPTION	R.H.
5	1/22/19	REAR BODY STEP UPGRADE	SS
4	08/10/18	ENGINE UPDATES	TA
3	08/10/18	SUCTION HOSE MOVE	TA
2	07/16/18	COA	CS/DJ/LA
1	06/15/18	PRECON REVIEW	TA/DJ/CS
0	02/21/18	INITIAL PROPOSAL	R.H.

CUSTOMER: NIESA
 SCALE: NOT TO SCALE

TRUCK NUMBER: 218082
 DEALER: ZAHNEN