

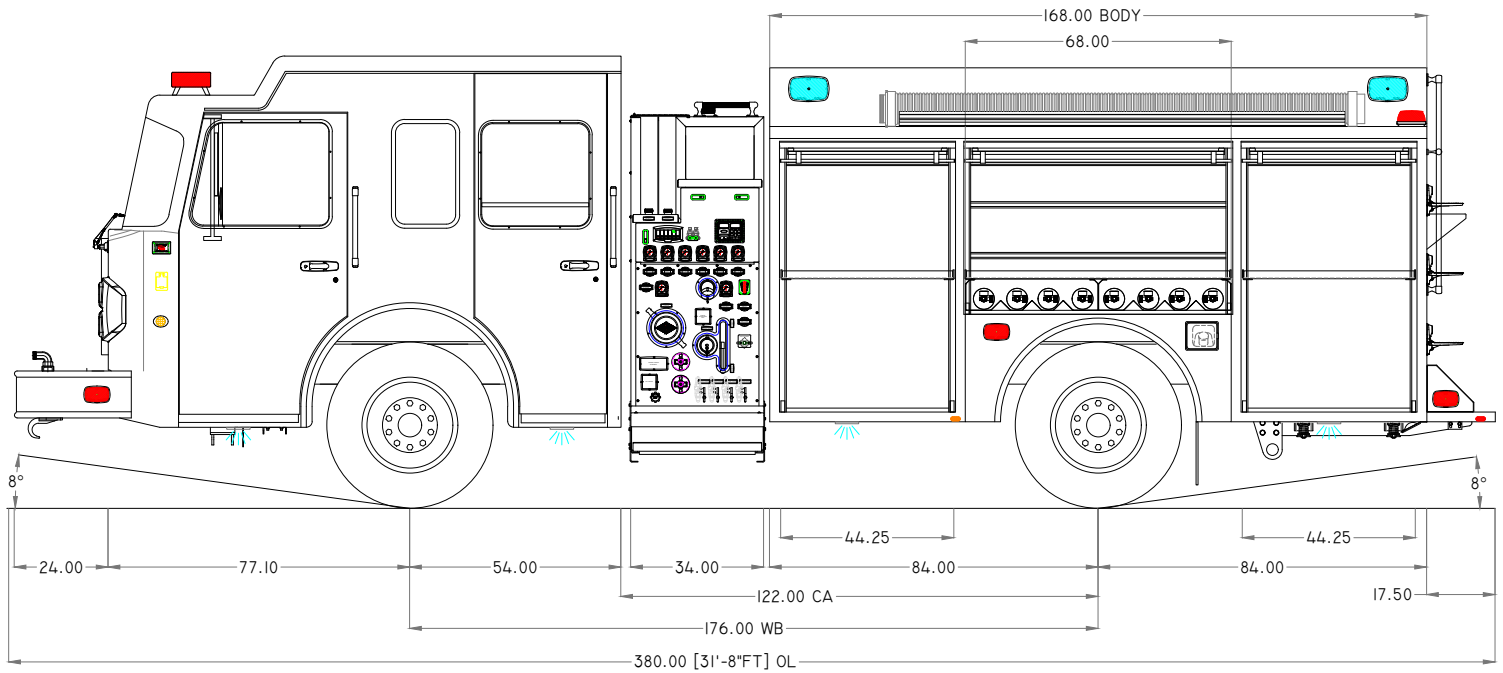

S-180 PUMPER MODEL 2108

REV GROUP



Chassis

- Spartan Metro Star MFD 10" Raised Roof
- Seating Capacity 6
- Cummins ISL 380 HP
- Allison 3000 EVS Transmission
- Extreme Duty Interior
- Occupant Advanced Protection System
- Front: 18,000 lbs Rear: 24,000 lbs.
- 24" Front Bumper Extension
- 176" Wheelbase
- Rearview Backup Camera
- Goodyear Tires
- Dual Air Horns

Pump and Plumbing

- Hale DSD 1500 GPM Pump
- Class 1 TGP Plus Pressure Governor
- 1000 Gallon Tank Capacity
- 20 Gallons Foam
- (1) 2.5" Left Side Auxiliary Inlet
- (1) 2.5" Left Side Discharge
- (1) 2.5" Right Side Discharge
- (1) 3" Right Side Discharge w/4" Storz
- (1) 2.5" Left Rear Discharge
- (1) 3" Deck Gun Discharge
- (2) 1.75" Crosslays
- (1) 1.5" Front Bumper Discharge

Body

- 168" Formed Aluminum Body
- Vibra-Torque Body Mounting System
- ROM Roll-up Doors
- Full Depth Left/Split Depth Right/Ladders Right
- Left Side Overwheel SCBA Storage
- 15" Hosebed Riser Side Walls
- Durable Compartment Finish
- LED Compartment Lighting
- Whelen LED Lighting Package
- (4) Whelen M9 LED Side Scene Lights
- (2) Whelen M9 LED Rear Scene

Compartment	Volume (Cubic Feet)
L1	36.4
L2	27.4
L3	36.4
R1	36.4
R2	27.4
R3	36.4
B1	31.2
Hose Bed Area	94.1

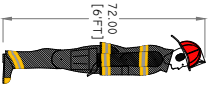
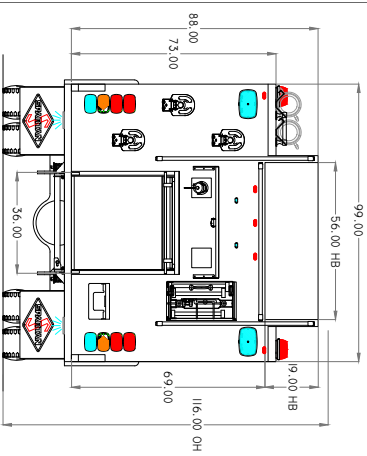
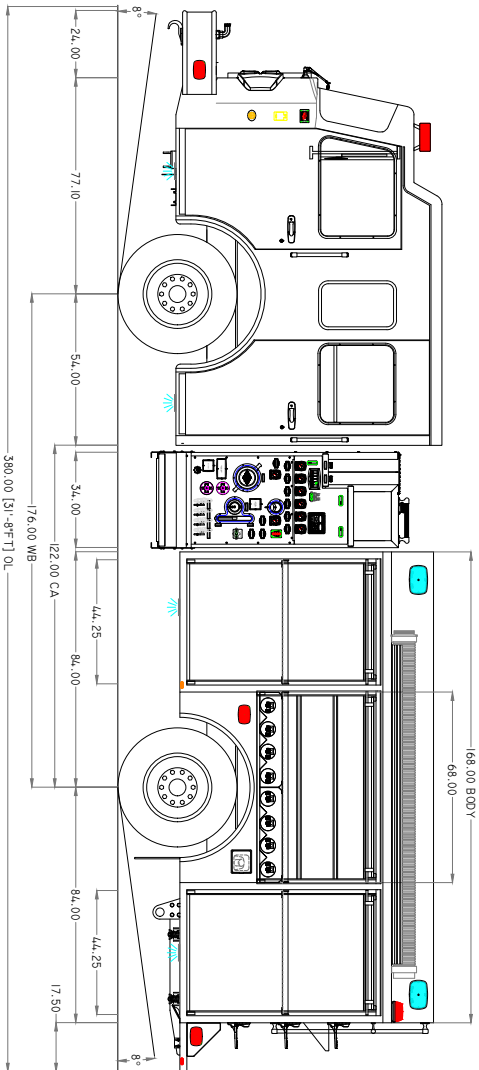
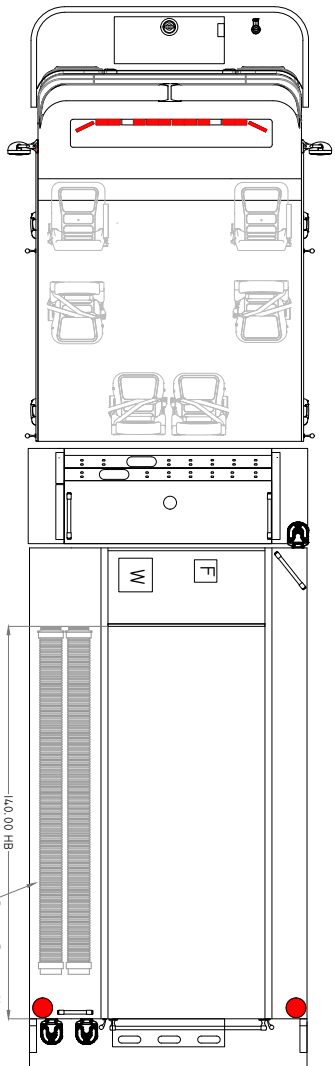
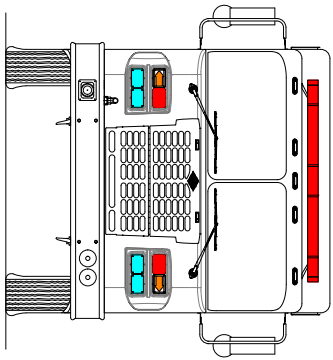

CHASSIS: SPARTAN METRO STAR MFD 10' RR

ENGINE: CUMMINS L9 380HP

TRANSMISSION: ALLISON 3000 EVS

AXLES: F 18,000 LB / R 24,000 LB

WATER/FOAM: 1000 GALLONS / 20 GALLONS

WATER PUMP: HAILE DSD 1500 GPM

FOAM SYSTEM: GENERATOR

GENERATOR: DOOR FRAMED OPENINGS

COMPARTMENT DOOR FRAMED OPENING

L2 68.0-W X 4.3-O-H

L3 44.25-W X 6.8-O-H

R1 44.25-W X 6.8-O-H

R2 68.0-W X 4.3-O-H

R3 44.25-W X 6.8-O-H

B1 3.6-O-W X 37.25-H

SPECIAL NOTES

LADDER PACKAGE:

(1) DUCK-SWEET 24 FT. 2 SEC. 900A

(1) DUCK-SWEET 14 FT. ROOF 775A

(1) DUCK-SWEET 10 FT. AITC 585A

STORAGE FOR:

(2) 10' HAIR SUCTION HOSES

(2) STANDARD HOOP PINE FOLDS

CUSTOMER

THIS DRAWING IS A CLOSE APPROXIMATION OF YOUR FIRE APPARATUS. IN ALL CASES WHERE THE DRAWING AND THE WRITTEN SPECIFICATION DIFFER, THE SPECIFICATION SHALL PREVAIL. THE DRAWING IS FOR INFORMATION ONLY. THE WRITTEN SPECIFICATION REPRESENTS WHAT YOU WANT IN YOUR FINISHED PRODUCT. SPARTAN EMERGENCY RESPONSE BUILDS TO ASSURE THAT YOUR WISHES ARE MET.

PROPRIETARY AND CONFIDENTIAL

THE INFORMATION CONTAINED IN THIS DRAWING IS THE SOLE PROPERTY OF SPARTAN EMERGENCY RESPONSE. ANY REPRODUCTION OR TRANSMISSION OF THIS DRAWING WITHOUT THE WRITTEN PERMISSION OF SPARTAN EMERGENCY RESPONSE IS PROHIBITED. SPARTAN MOTORS USA, NC, D/B/A SPARTAN EMERGENCY RESPONSE.

REV	DATE	DESCRIPTION	NAME
5	2/28/19	FOLDING STEP UPGRADE	SS/XX/XX
4	11/2/18	ENG UPGRADE-MIGRATION SS/D/D/G	
3	5/10/17	ADDITIONAL MARKUPS	W.C.
2	4/11/17	CHANGES FROM MARKUP	
1	01/27/16	T RUCK REVIEW	M.G.H.
0	05/13/15	INITIAL PROPOSAL	M.G.H.

SCALE: NOT TO SCALE

CUSTOMER: _____

TRUCK NUMBER: _____ DEALER: _____

MODEL 2108-08